

# House District 31 | Rep. Garry Mize

**HD 31** had **36,849** people when it was redistricted in 2011. The target population at that time was **37,142** people per House District.

Now it has an estimated **42,745** people, according to the latest numbers from the American Community Survey, a program of the U.S. Census Bureau.

The current estimate is **3,806** away from the estimated district target of **38,939** people, which is determined by dividing our estimated statewide population (3,932,870) by the 101 House Districts.

The district's population has changed an estimated **16%** between 2010 and now.

- 89.7% of the district is White, alone or in combination with one or more other races.
- 7% of the district is Black or African American, alone or in combination with one or more other races.
- 6.2% of the district is American Indian and Alaskan Native, alone or in combination with one or more other races.
- 1.5% of the district is Asian, alone or in combination with one or more other races.
- 0.3% of the district is Native Hawaiian and Other Pacific Islander, alone or in combination with one or more other races.
- 0.7% of the district is some other race.
- 7.2% of the district is of Hispanic or Latino origin.

## Congressional Districts

3, 5

## Senate Districts

20, 22, 41

## Counties

Logan, Oklahoma

## Cities

Cashion, Cedar Valley, Cimarron City, Edmond, Guthrie

## Census Block Groups in HD 31

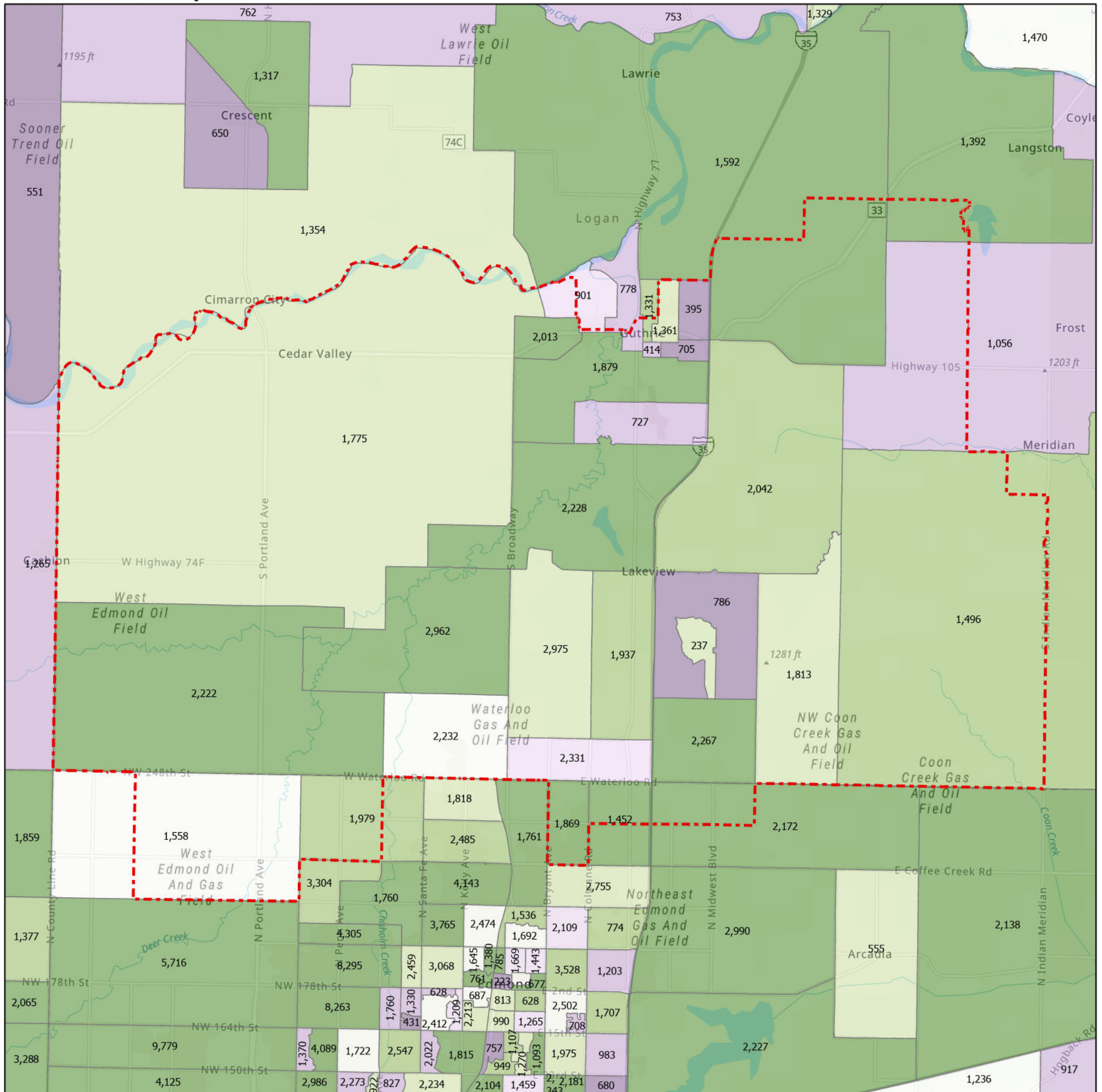

**HD 31**

**Census Block Groups**  
(Label = 2019 population estimate)

Percent change, 2010-2019

More losses   More gains

12/31/2020  
Source: U.S. Census Bureau, 2015–2019 American Community Survey 5-Year Estimates. ACS data are based on a sample and are subject to sampling variability. Each estimate has a margin of error. The sum of the racial categories sometimes exceeds 100% because survey participants can select more than one racial category. Hispanic origin is of any race.

